



ONE PALM

Managed by
Dorchester Collection

4 Bedroom Residence

Unit 403 – 4th Floor

4 Bedrooms – 4 Bathrooms – 4 Parking Spaces

Residence	4,731 sq. ft.	439 sq. mt.
Terrace	792 sq. ft.	74 sq. mt.
Total	5,523 sq. ft.	513 sq. mt.

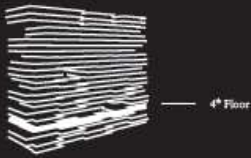

4th Floor



Features

Private and Semi-Private Lift Lobby
Step into your lift lobby designed by acclaimed Japanese designer firm Super Potato, this area will create an environment of tranquility before you even enter your stunning residence.

Grand Main Entrance
A magnificent grand foyer serves as an impressive first step into a home of remarkable distinction.

Show Kitchen and Preparation Kitchens
Fully fitted Italian kitchen from Varenna by Poliform, integrated Gaggenau cooking, cooling and cleaning appliances supported by a European preparation kitchen with integrated Miele appliances.

Formal Dining
Entertain guests in an environment of inspired elegance and charm.

Wardrobes
Beautifully crafted walk-in closets and wardrobes by Poliform offer generous storage for every bedroom.

En-suite Rooms with Balcony/Juliet Balcony
A spacious, completely private space with the most impressive views.

Maid's Room and Bathroom
Private quarters for maids allow for complete ease of living.

Laundry Room
Each residence comes with a dedicated laundry area.

Storage Room
Ample room to allow for a clutter-free home.

Floor to Ceiling Windows
Stunning views flood each interior space with natural light and provide an inspiring backdrop throughout each home.

Private Terrace
Escape to a relaxing, private outdoor haven that offers the perfect setting to savor a delicious barbecue under a starlit Arabian sky.

